

1. MECHANICAL DIMENSIONS:

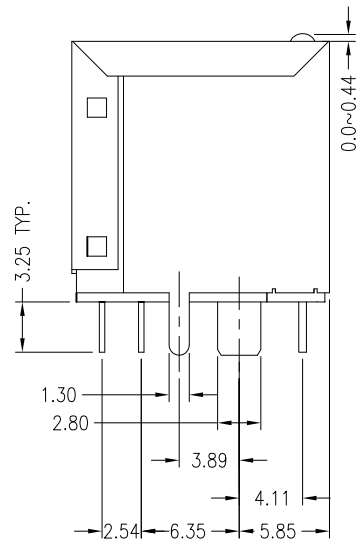

2. LED SCHEMATIC:

LEFT LED:

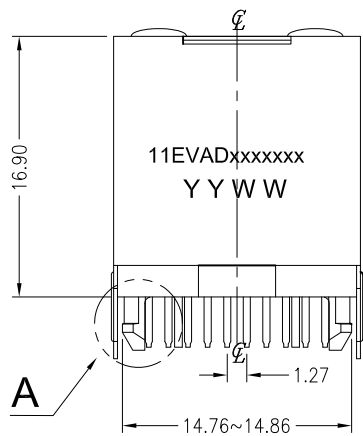
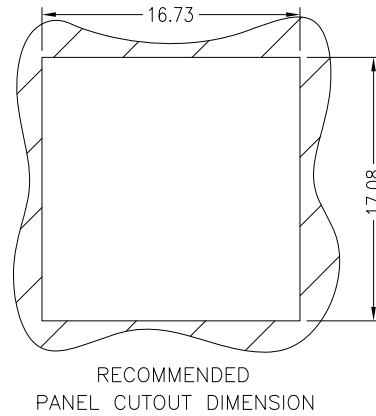
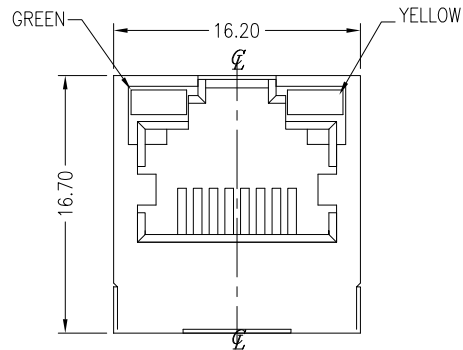
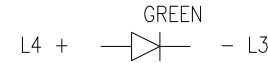

RIGHT LED:



3. PCB LAYOUT:

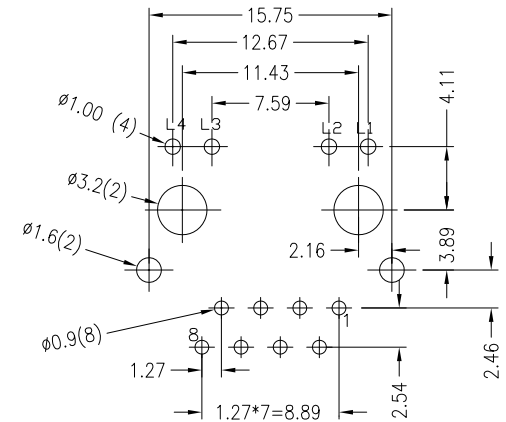

SUGGESTED PCB LAYOUT
(TOP VIEW)
DIMENSIONAL TOLERANCE: ±0.05

NOTES:

1. MATERIALS:

HOUSING: PBT POLYESTER UL94V-0
MIXED 30% GLASS FIBER.
STANDARD COLOR-BLACK.
CONTACTS:0.35mm THICK PHOS-BRONZE PLATED
WITH GOLD PLATING ON CONTACT AREA.

SHIELD: SUS304,THICKNESS=0.20mm

2. OPERATING TEMPERATURE: 0°C TO +70°C

3. CAVITY CONFORMS TO FCC RULES AND REGULATIONS
PART 68,SUBPART F.

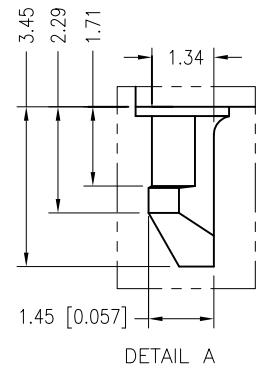

4:1

| REV. | ECN. NO. | DRAWN | DATE |
|------|----------|-------|------------|
| A | NEW | John | 24/03/2015 |
| | | | |
| | | | |

DST-conn Tech. Co., Ltd.



| ⊗:QUALITY CONTROL ITEM | | GENERAL TOLERANCE | | PART NO.: 11EVAD-xxxx-xxx | | |
|------------------------|--|-------------------|---------|------------------------------|------------|------------|
| APPROVED | | .X± 0.38 | X.'± 2' | TITLE:RJ45 1X1 PORT 180D PBT | | |
| CHECKED | | .XX± 0.25 | .X'± 1' | 10/100MBPS FILTER 8P8C | | |
| DRAWN | | .XXX± 0.13 | | UNIT: mm | SCALE: 1:1 | SHEET: 1/3 |
| | | | | | | REV.: A |

説明: △ :備註 ◇ :版本變更 ① :尺寸序號 ■ :重點尺寸 ▼ :CPK尺寸

1

2

3

SIZE: A4

4. SCHEMATIC:

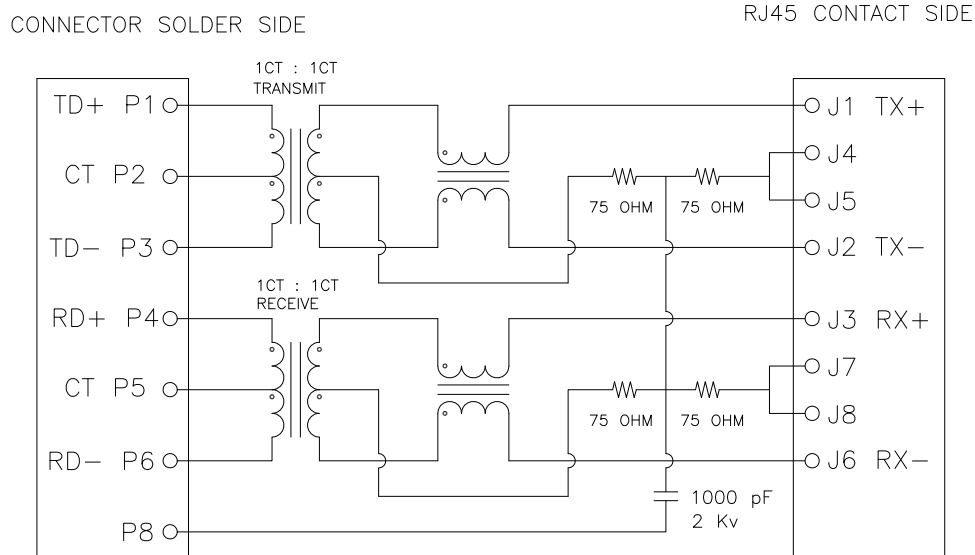

5. ELECTRICAL CHARACTERISTICS :

TEST NOTES:(25±5°C)

1. TR:(100KHz,0.1V);
PINS:(P1,P3):(J1,J2)=1:1±3% (P4,P6):(J3,J6)=1:1±3%
2. LX:(100KHz,100mV,8mA, DC Bias)
PINS: (P1,P3),(P4,P6)=350uH MINIMUM
3. DCR:
PINS:(J1,J2),(J3,J6)=1.2Ω MAXIMUM
4. HIPOT:
PINS(P1,P3)TO(J1,J2)=1500VAC FOR 60 SECONDS
PINS(P4,P6)TO(J3,J6)=1500VAC FOR 60 SECONDS
5. INSERTION LOSS:
-1.0dB MAXIMUM AT 1MHz TO 100MHz;
6. RETURN LOSS:
-20dB MINIMUM AT 1MHz TO 30MHz;
-15dB MINIMUM AT 30MHz TO 60MHz
-10dB MINIMUM AT 60MHz TO 80MHz
7. CROSS TALK:
-30dB MINIMUM AT 1MHz TO 100MHz
8. COMMON TO COMMON MODE REJECTION:
-30dB MINIMUM AT 1MHz TO 100MHz

| REV. | ECN. NO. | DRAWN | DATE |
|------|----------|-------|------------|
| A | NEW | John | 24/03/2015 |
| | | | |
| | | | |

DST-conn Tech. Co., Ltd. **HSF** Compliant

| ⊗:QUALITY CONTROL ITEM | | GENERAL TOLERANCE | PART NO.: 11EVAD-xxxx-xxx | | |
|------------------------|--|-------------------|--|------------|------------|
| APPROVED | | .X± 0.38 X.'± 2' | TITLE:RJ45 1X1 PORT 180D PBT 10/100MBPS FILTER 8P8C | | |
| CHECKED | | .XX± 0.25 .X'± 1' | | | |
| DRAWN | | .XXX± 0.13 | UNIT: mm | SCALE: 1:1 | SHEET: 2/3 |
| | | | | | REV.: A |

説明: △ :備註 ◇ :版本變更 ④ :尺寸序號 ■ :重點尺寸 ▼ :CPK尺寸

SIZE: A4

1 2 3 4 5 6 7 8

F
E
D
C
B
A

F
E
D
C
B
A

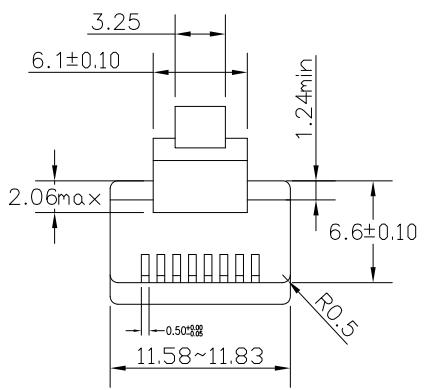

* There must be no damage to housing or locking latch. There must be no nicks or cuts in cable.
* Durability : 750 cycles generally

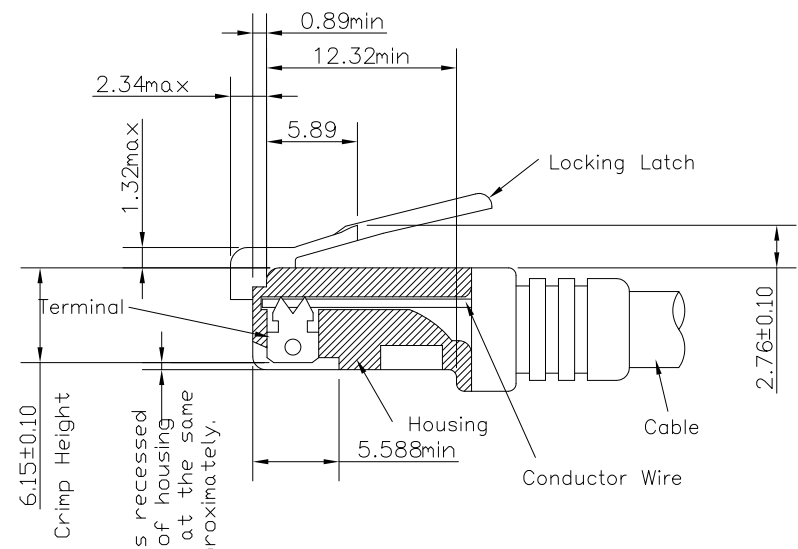

All contacts recessed below top of housing and must be at the same height approximately.

FOLLOW SPECIFICATION : FCC, PART 68, SUBPART F FIGURE 68.500 (C)(2)(i) AND IEC 603-7 FIGURE 23 & 24

STANDARD MODULAR PLUG ASSEMBLY

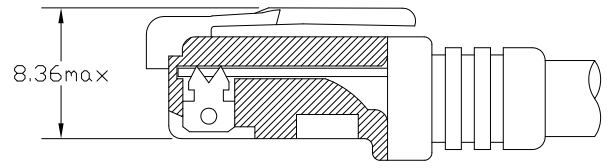

FOLLOW SPECIFICATION : FCC, PART 68, SUBPART F FIGURE 68.500 (C)(2)(ii)

| REV. | ECN. NO. | DRAWN | DATE |
|------|----------|-------|------------|
| A | NEW | John | 24/03/2015 |
| | | | |
| | | | |



| ⊗:QUALITY CONTROL ITEM | | GENERAL TOLERANCE | PART NO.: 11EVAD-xxxx-xxx | | | |
|------------------------|--|-------------------|--|------------|------------|---------|
| APPROVED | | .X± 0.38 X:± 2' | TITLE:RJ45 1X1 PORT 180D PBT 10/100MBPS FILTER 8P8C | | | |
| CHECKED | | .XX± 0.25 .X:± 1' | | | | |
| DRAWN | | .XXX± 0.13 | UNIT: mm | SCALE: 1:1 | SHEET: 3/3 | REV.: A |

説明: △ :備註 ◇ :版本變更 ㊦ :尺寸序號 ■ :重點尺寸 ▼ :CPK尺寸

1 2 3

SIZE: A4