

REV.	ECN. NO.	DRAWN	DATE
A	NEW	JOHN	28/03/2015

DST-conn Tech. Co., Ltd. **HSF** Compliant

⊗:QUALITY CONTROL ITEM		GENERAL TOLERANCE	PART NO.:
APPROVED		.X± 0.38 X.'± 2'	22JS66D-xxxxx
CHECKED		.XX± 0.25 .X'± 1'	TITLE:RJ45 2X2 PORT 8P8C
DRAWN		.XXX± 0.13	W/ LED , SHELL , T/S
		UNIT: mm	SCALE: 1:1
			SHEET: 1/2
			REV.: A

説明: △ :備註 ◇ :版本變更 ④ :尺寸序號 ■ :重點尺寸 ▼ :CPK尺寸

SIZE: A4

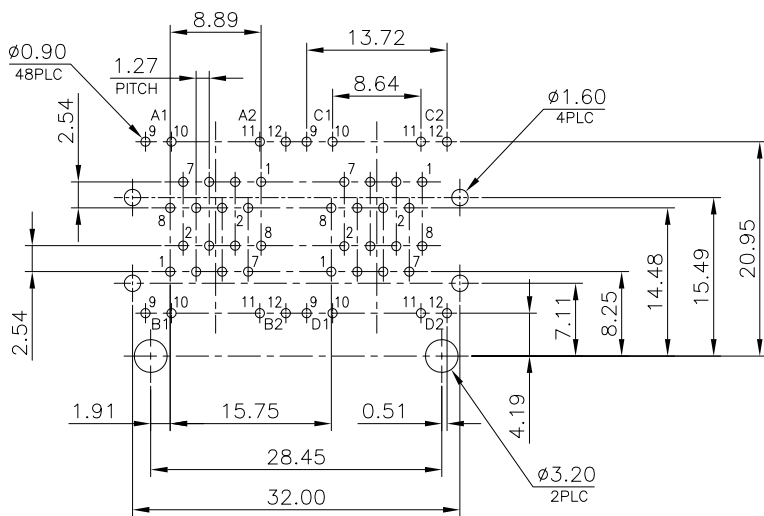

RECOMMENDED PCB LAYOUT

RECOMMENDED PCB THICKNESS: 1.6mm
TOLERANCE: ± 0.05 (TOP VIEW)

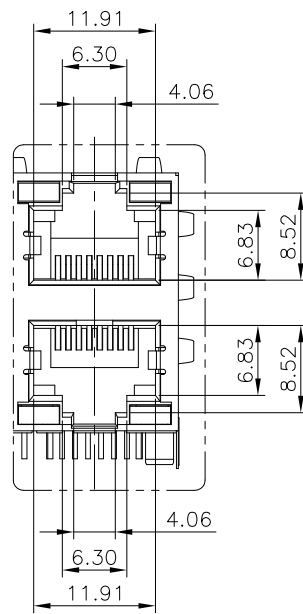
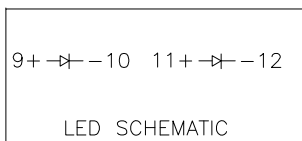

DETAIL C

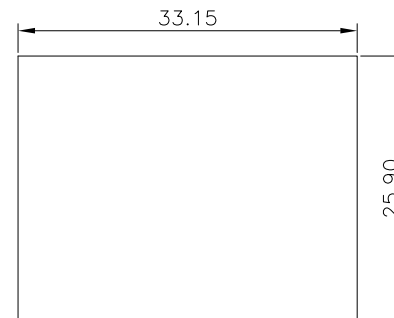

RECOMMENDED PANEL CUTOUT

NOTE:

CAVITY CONFIRMS TO FCC RULES AND REGULATIONS PART 68, SUBPART F.

1. MATERIAL:

- 1.1 BOTTOM HOUSING: PA46, WITH GLASS FIBER, UL94V-0, STANDARD COLOR-BLACK.
- 1.2 BOTTOM INSERT HOUSING: PA46, WITH GLASS FIBER, UL94V-0, STANDARD COLOR-BLACK.
- 1.3 TOP HOUSING: PBT, WITH GLASS FIBER, UL94V-0, STANDARD COLOR-BLACK.
- 1.4 TOP INSERT HOUSING: PBT, WITH GLASS FIBER, UL94V-0, STANDARD COLOR-BLACK.
- 1.5 CONTACTS: PHOSPHOR BRONZE.
- 1.6 LED: STEEL.
- 1.7 SHIELD: BRASS.

2. FINISH:

- 2.1 CONTACTS: GOLD PLATED ON CONTACT AREA, $0.0254\mu\text{m}$ [$1\mu''$] GOLD PLATED ON SOLDER TAIL, WITH ENTIRE CONTACT UNDERPLATED $1.27\mu\text{m}$ [$50\mu''$] MIN. NICKEL
- 2.2 LED SOLDER TAIL: $2.54\mu\text{m}$ [$100\mu''$] MIN. TIN PLATED.
- 2.3 SHELL: $0.508\mu\text{m}$ [$20\mu''$] MIN. NICKEL PLATED.

REV.	ECN. NO.	DRAWN	DATE
A	NEW	JOHN	28/03/2015



⊗:QUALITY CONTROL ITEM		GENERAL TOLERANCE		PART NO.: 22JS66D-xxxxx		
APPROVED		.X \pm 0.38	X. \pm 2'	TITLE:RJ45 2X2 PORT 8P8C		
CHECKED		.XX \pm 0.25	.X' \pm 1'	W/ LED , SHELL , T/S		
DRAWN		.XXX \pm 0.13		UNIT: mm	SCALE: 1:1	SHEET: 2/2
						REV.: A

説明: \triangle :備註 \diamond :版本變更 \textcircled{N} :尺寸序號 \blacksquare :重點尺寸 \blacktriangledown :CPK尺寸

SIZE: A4