

F

E

D

C

B

A

RoHS Compliant

SYMBOL

REV.

REVISION

APPROVAL

DATE

A

新版圖紙

Winky

2010.06.20

备注:

特性:

额定电压 : 250V

额定电流 : 5AMP

接触阻抗 : 30mΩ MAX.

绝缘阻抗 : 1000MΩ MIN. at 500V DC

耐电压值 : 500V AC RMS for 1Minute

温度范围 : -20C° - 85C°

2. 材料:

塑胶 : PBT+30% G.F(UL94V-0) BLACK

端子 : 黄铜, 表面镀半金锡 G/F

外壳 : SPCC, 表面镀镍

Z字片 : SPCC , 表面镀锡

铆钉 : SPCC , 表面镀镍

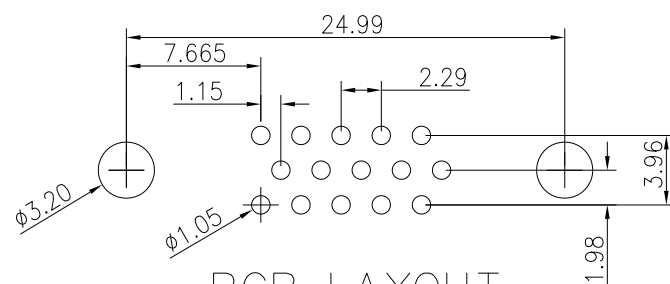
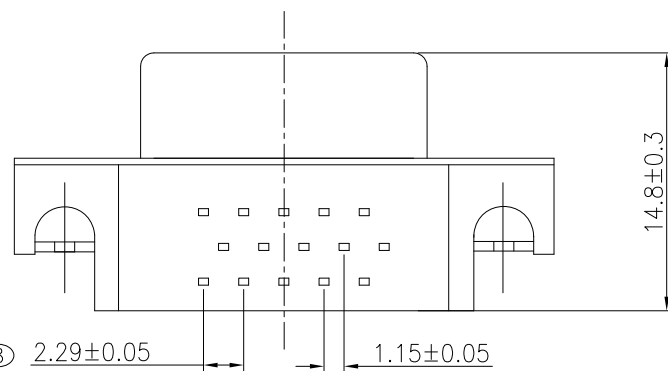
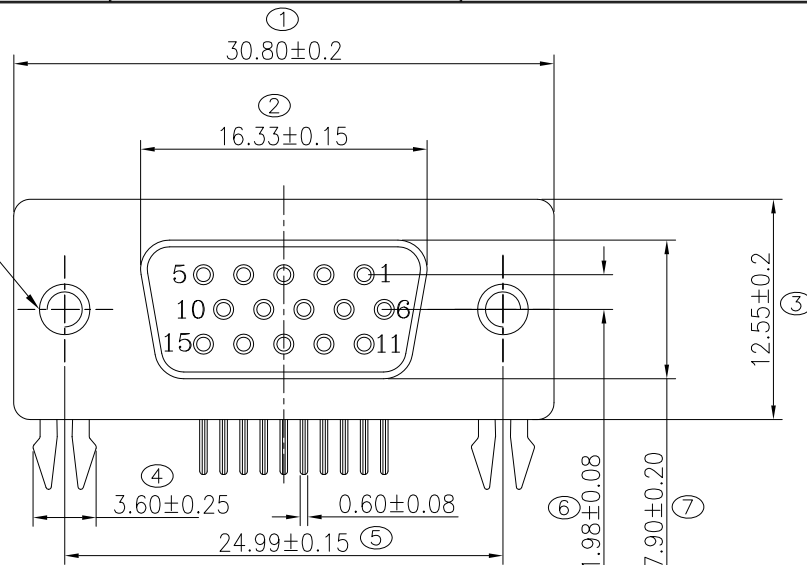

PCB LAYOUT

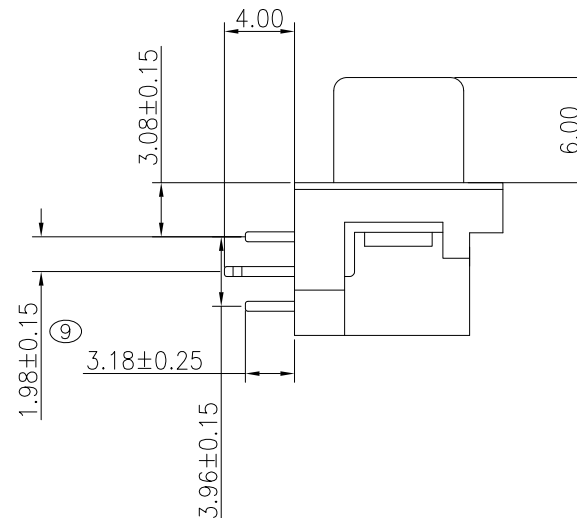

DST-conn Tech. Co., Ltd.

COPYRIGHT RESERVED, PLEASE DO NOT COPY.

PART NAME		DR 3.08 母头 15PIN 铆合		DRAWING	Winky	DWG. No.	DD02
PART NO.		DD02-SDGB015TLKE		CHECK	Roy	REV.	A
UNIT :	TOLERANCE UNLESS	X.X ± 0.20	ANGLE	APPROVAL	John	DATE	2010.06.20
	mm	X.XX ± 0.15		±2°	SCALE	1:1	PAGE
OTHERWISE SPECIFIED		X.XXX ± 0.05					

F

E

D

C

B

A