

PIN NO.	Dimension			PIN NO.	Dimension		
	A	B	C		A	B	C
04	8.60	3.00	5.07	19	23.60	18.00	20.07
05	9.60	4.00	6.07	20	24.60	19.00	21.07
06	10.60	5.00	7.07	21	25.60	20.00	22.07
07	11.60	6.00	8.07	22	26.60	21.00	23.07
08	12.60	7.00	9.07	23	27.60	22.00	24.07
09	13.60	8.00	10.07	24	28.60	23.00	25.07
10	14.60	9.00	11.07	25	29.60	24.00	26.07
11	15.60	10.00	12.07	26	30.60	25.00	27.07
12	16.60	11.00	13.07	27	31.60	26.00	28.07
13	17.60	12.00	14.07	28	32.60	27.00	29.07
14	18.60	13.00	15.07	29	33.60	28.00	30.07
15	19.60	14.00	16.07	30	34.60	29.00	31.07
16	20.60	15.00	17.07				
17	21.60	16.00	18.07				
18	22.60	17.00	19.07				



REV.	SYMBOL	REVISION	APPROVAL	DATE
A	/	新版圖紙	Winky	2013/08/18

NOTES:

- MATERIAL:
  - 1-1. HOUSING: HIGHT-TEMP PLASTIC(WITHOUT HALOGEN) UL94V-0 COLOR:NATURE;
  - 1-2. COVET: HIGHT-TEMP PLASTIC(WITHOUT HALOGEN) UL94V-0 COLOR:BLACK;
  - 1-3. CONTACT: COPPER ALLOY;
  - 1-4. PEG: COPPER ALLOY;
- PLATING:
  - 2-1. CONTACT: GOLD OR TIN PLATED ON NICKEL OVERALL.
  - 2-2. PEG: TIN PLATED ON NICKEL OVERALL.
- RATING:
  - 3-1. CURRNET RATING: 0.5A AC/DC.
  - 3-2. VOLTAGE RATING: 50V AC/DC.
  - 3-3. TEMPERATURE RANGE: -45°C ~ +85°C

PART NO. (P/N):  
DF16-SEN x xx RH10S

- PIN NO.
- PLATING:
- 0: G/F
  - M: MATTE TIN OVER NICKEL
  - B: BRIGHT TIN OVER NICKEL

**DST**-conn Tech. Co., Ltd.

PART NAME		1.0Pitch 2.0H FPC EASY-ON R/A SMT TYPE		DESIGN	Winky/2013.08.18	TITLE	
PART. NO.		DF16-SENxxxRH10S		DRAWING	Winky/2013.08.18	DWG. NO.	DF16
UNIT: mm	MATERIAL	TOLERANCE UNLESS OTHERWISE SPECIFIED: xx±0.25 xxx±0.15 xxxx±0.10	ANGLE	CHECK	Roy/2013.08.18	REV.	A
	*		0° ±2°	APPROVAL	John/2013.08.18	SHEET	1/2

F E D C B A

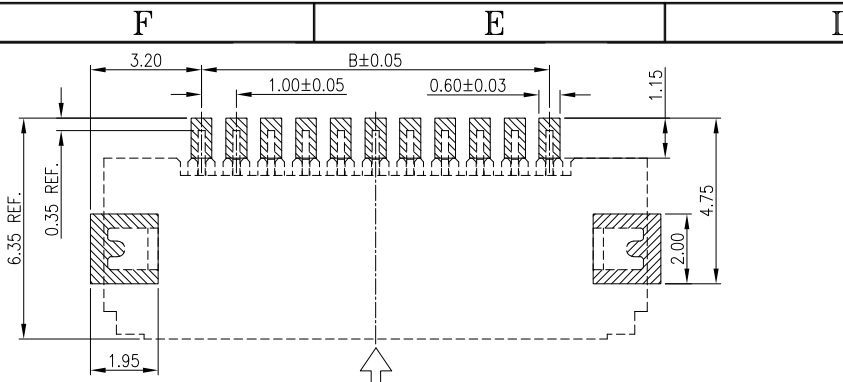

FFC/FPC INSERT DIRECTION  
RECOMMEND PCB LAYOUT  
04~30PIN Situation

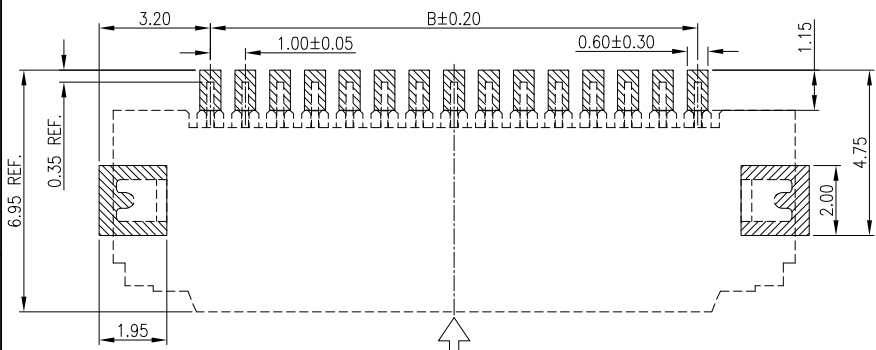

FFC/FPC INSERT DIRECTION  
RECOMMEND PCB LAYOUT  
31~60PIN Situation

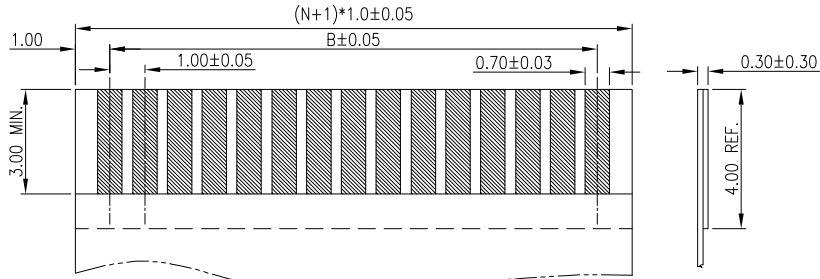

APPLICABLE FFC/FPC



REV.	SYMBOL	REVISION	APPROVAL	DATE
A	/	新版圖紙	Winky	2013/08/18

- NOTES:  
1. ALL DIMENSION MEET EIA-481-3 REQUIREMENTS;  
2. CARRRIER MATERIAL:PS BLACK;  
3. PACKING QULITY:2000PCS/REEL.

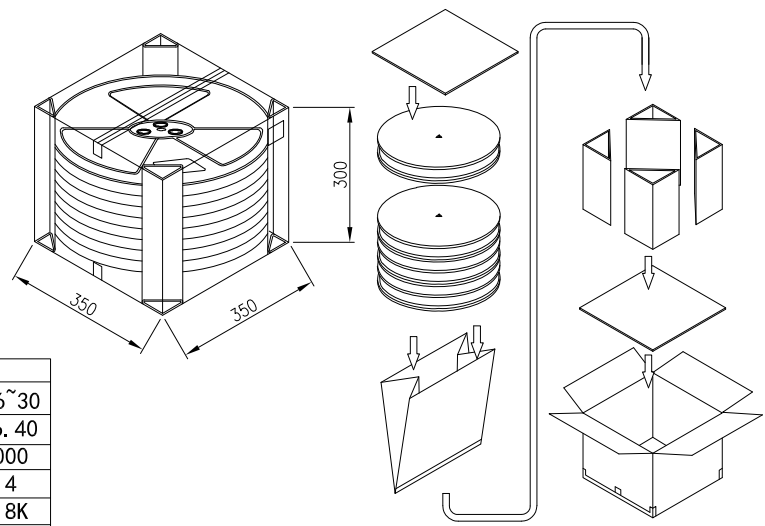
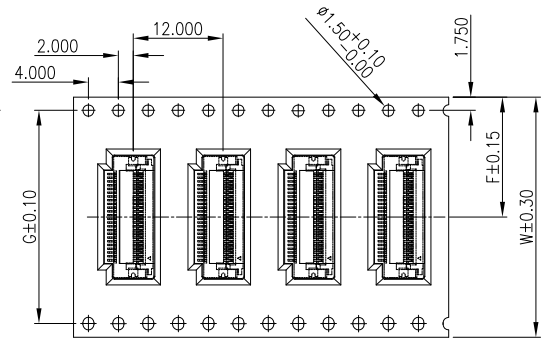
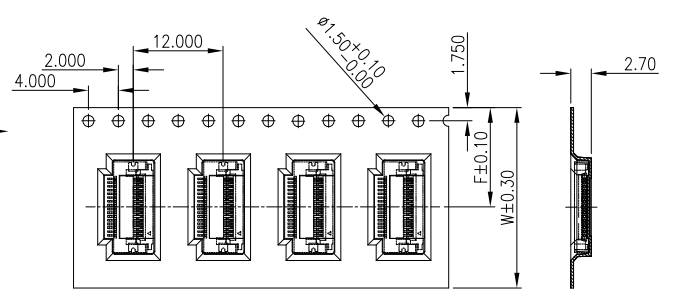
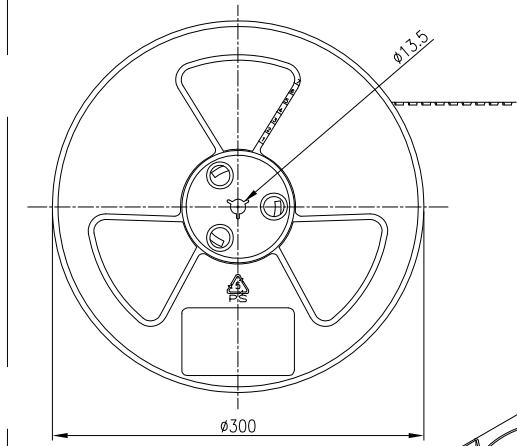
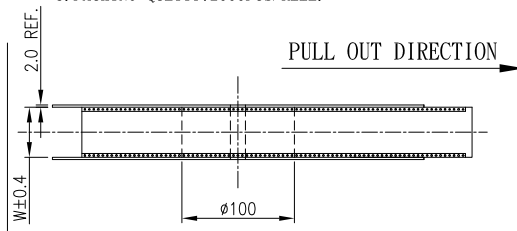

PIN NO.	Dimension		
	W	F	G
04~11	24.40	11.50±0.10	—
12~13	32.00	14.20±0.10	28.40
14~25	44.40	20.20±0.15	40.40
26~30	56.00	26.20±0.15	52.40

PACKING DISCRIPTION				
PIN NO.	04~11	12~13	14~25	26~30
REEL WIDTH	24.40	32.40	44.40	56.40
PCS/REEL	2000	2000	2000	2000
REEL/BOX	9	7	5	4
BOX/PCS	18K	14K	10K	8K
CTN. SINE	350*350*300			

**DST-conn Tech. Co., Ltd.**

PART NAME	1.0Pitch 2.0H FPC EASY-ON R/A SMT TYPE	DESIGN	Winky/2013.08.18	TITLE	
PART. NO.	DF16-SENxxxRH10S	DRAWING	Winky/2013.08.18	DWG. NO.	DF16
UNIT:	MATERIAL	TOLERANCE UNLESS OTHERWISE SPECIFIED: xx±0.25 xx±0.15 xxx±0.10	ANGLE	REV.	A
mm	*	0° ±2°	APPROVAL	John/2013.08.18	SHEET
					2/2