

RoHS Compliant

SYMBOL	REV.	REVISION	APPROVAL	DATE
	A	新版圖紙	Winky	2013.06.17

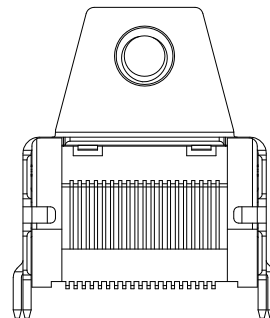
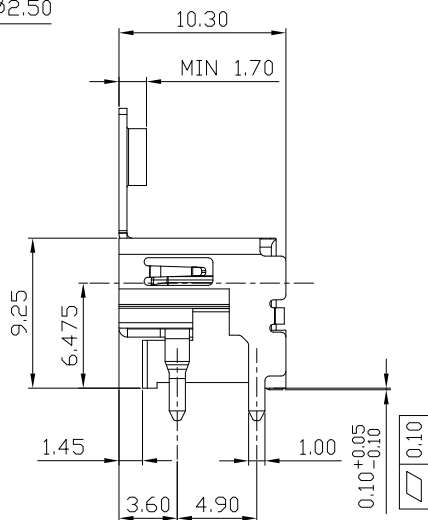
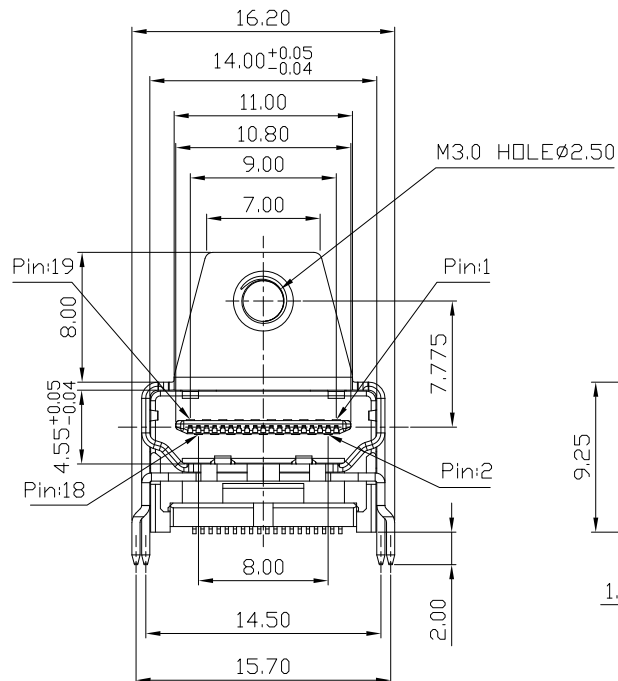
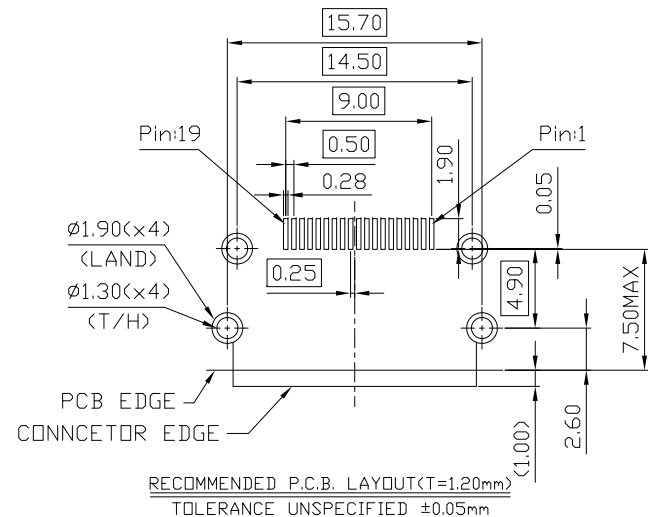
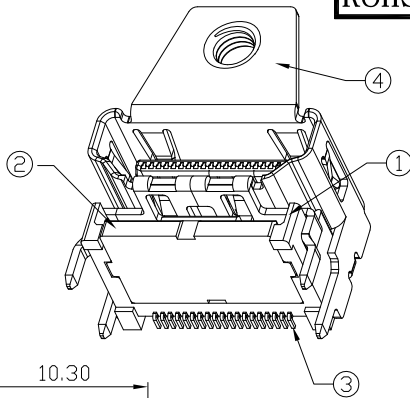
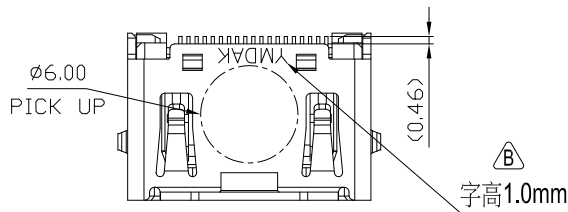

- NOTES:
- MATERIAL SPECIFICATION:
 - 1-1: HOUSING: LCP+30%G.F.BLACK UL94V-0
 - 1-2: STOPPER:LCP+30%G.F.BLACK UL94V-0
 - 1-3: CONTACT:BRASS C2680R-H,T=0.20mm
 - 1-4: SHELL:BRASS C2680R-H,T=0.50mm
 - PLATING SPECIFICATION:
 - 2-1: CONTACT: Ni 30u" Min UNDERPLATED OVER ALL
Au 5u" PLATED ON CONTACT AREA
Au 1u" PLATED ON SOLDER AREA
 - 2-2: SHELL: Ni 40u" Min UNDERPLATED OVER ALL
 - MECHANICAL PERFORMANCE:
 - 3-1: INSERTION FORCE: 44.1N(4.5KGF)MAX
 - 3-2: WITHDRAWAL FORCE: 9.8N~39.2N(1.0KGF~4.0KGF)
 - 3-3: RETENTION FORCE: 0.30KGF/PIN MIN
 - 3-4: DURABILITY: 10000 CYCLES
 - ELECTORICAL PERFORMANCE:
 - 4-1: CURRENT RATING: 0.5A MIN
 - 4-2: LLCR:CONTACT: 30mΩ MAX, SHELL:50mΩ MAX
 - 4-3: INSULATION RESISTANCE:
 - A:UNMATED: 100 MΩ MIN. AT 500V DC
 - B:MATED: 10 MΩ MIN. AT 150V DC
 - 4-4:DIELECTRIC WITHSTAND VOLTAGE:
 - 300V AC/60S(MATED),500V AC/60S(UNMATED),

DATE CODE INFORMATION:
Y M D A K
YEAR MONTH DATE LINES
KSI
DATE

YEAR: 0~9
MONTH: 1~9 A~C
DATE: 1~9 A~V
LINES: A~Z

ITEM	PART NAME	MATERIAL	QTY
④	SHELL	C2680R-H,T=0.50,	1pcs
③	CONTACT	C2680R-H,T=0.20,Au 5u"	1pcs
②	STOPPER	LCP+30%G.F.,BLACK,UL94V-0	1pcs
①	MOLDING HOUSING	LCP+30%G.F.,BLACK,UL94V-0	1pcs

DST-conn Tech. Co., Ltd.

COPYRIGHT RESERVED, PLEASE DO NOT COPY.

PART NAME	HDMI SMT TYPE CONNECTOR(H=9.25)有耳型	DRAWING	Winky	DWG. No.	DU15
PART NO.	DU15-HMEB219RLV	CHECK	Roy	REV.	A
UNIT :	TOLERANCE UNLESS X.X ±0.30 X.XX ±0.20 X.XXX ±0.10	APPROVAL	John	DATE	2013.06.17
mm	OTHERWISE SPECIFIED	SCALE	1:1	PAGE	1 OF 1

F E D C B A