

F

E

D

C

B

A

RoHS Compliant

SYMBOL

REV.

REVISION

APPROVAL

DATE

A

新版圖紙

Winky

2014. 05. 10

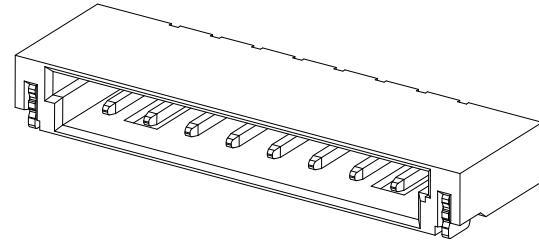
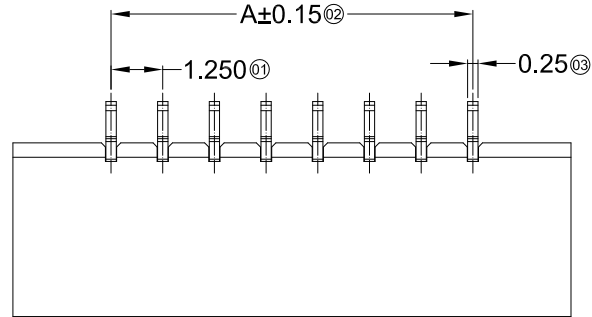

Specifications :

- Voltage rating: 200V AC / DC
- Current rating: 1A AC / DC
- Withstanding voltage: 500V AC/minute
- Temperature range: -25°C~+85°C
- Insulation resistance: ≥100MΩ
- Contact resistance: ≤40mΩ
- After environmental testing: ≤80mΩ

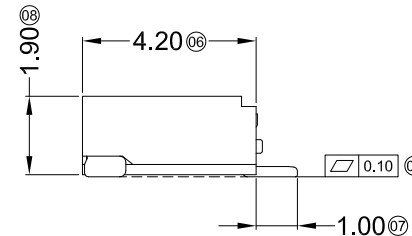
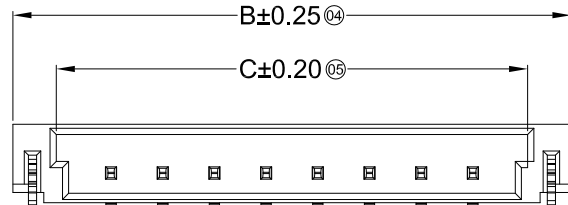

DW32 - W S E x xx RLW

① ② ③ ④ ⑤ ⑥

- ① Series No.
- ② Category: W: wafer
- ③ Welding Board Angle&Way: S: SMT ,Right Angle 90°
- ④ Material: E: LCP 94V-0
- ⑤ Planting Category: 0:Gold Flash M:Matte Tin plating
- ⑥ Row No.-Pin No.: xx: 02P~30P

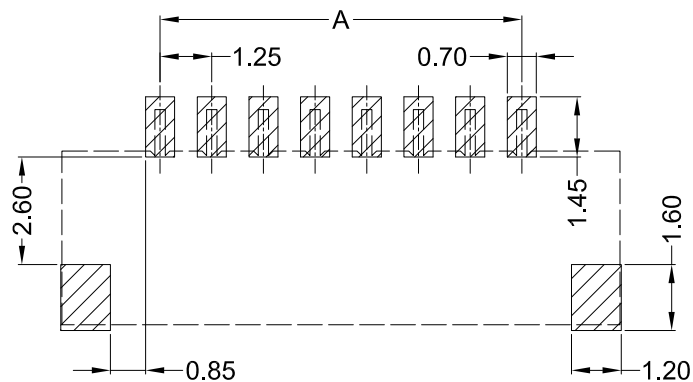

Recommended P.C.B Layout
General Tolerance±0.05

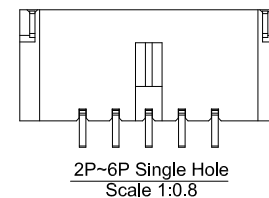
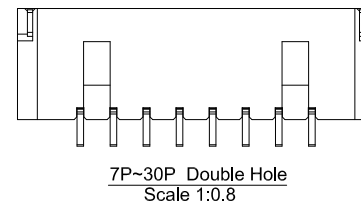

Poles	Dimensions(mm)			Poles	Dimensions(mm)		
	A	B	C		A	B	C
02	1.25	6.00	3.90	11	12.50	17.25	15.15
03	2.50	7.25	5.15	12	13.75	18.50	16.40
04	3.75	8.50	6.40	13	15.00	19.75	17.65
05	5.00	9.75	7.65	14	16.25	21.00	18.90
06	6.25	11.00	8.90	15	17.50	22.25	20.15
08	8.75	13.50	11.40	20	23.75	28.50	26.40
09	10.00	14.75	12.65	25	30.00	34.75	32.65
10	11.25	16.00	13.90	30	36.25	41.00	38.90

DW32-WSE0xxRLW	LCP UL 94V-0	Brass	Gold-Flash	DW32-H
DW32-WSEMxxRLW			Tin Plating Matte	
PART NO	Material	Material(Pin And Solder Tabs)	Finish Pin	Mates With Housing

DST-conn Tech. Co., Ltd.

COPYRIGHT RESERVED, PLEASE DO NOT COPY.

PART NAME	1.25mm Crimp Style Connectors		DRAWING	Winky	DWG. No.	DW32
PART NO.	DW32-WSExxxRLW		CHECK	Roy	REV.	A
UNIT : mm	TOLERANCE UNLESS	X. X ±0.30	APPROVAL	John	DATE	2014. 05. 10
	OTHERWISE SPECIFIED	X. XX ±0.20 X. XXX ±0.10				

F

E

D

C

B

A